



[www.iris-chains.com](http://www.iris-chains.com)

SINCE  
**1935**

## **Pusher chains and special chains**

Roller chains with carrier pins are designed and built to handle cans and tubes for processing through high speeds and temperatures

## Pusher chains and special chains

Roller chains with carrier pins are built to handle cans, tubes and other thin-walled items for processing through high speeds and temperatures.

IRIS pin oven chains maximize throughput even in such demanding conditions, thanks to their wear-resistance and the carrier pins' design features, which minimize downtime for maintenance.

### SERVICES

*Many references available in stock*

*Specific product on request*

*Length of carrier pins as requested by customer*

*Carrier pins distanced as required*

*Chains of any length*

*Special high-temperature lubrication provided*

*Technical assistance*

### Highlights

- ▶ A long service life is ensured thanks to the solid base chain and the wear-resistant, heat-treated components.
- ▶ Carrier pins are made of corrosion-resistant steels that provide excellent elasticity.
- ▶ Perfectly adjusted carrier pins allow a correct positioning of the items, even at the fastest speed, as well as an easy operability for the removal of the items.
- ▶ Carrier pins, assembled on to extended solid bushings and secured by bolts, are easy to change out on-site, minimizing downtime.
- ▶ Initial elongation is reduced by a pre-stressed test with optimal load.

### CARRIER PIN AND HEAD OPTIONS

Protective heads, made of high-performance materials, are available on aluminium, plastic or nylon.

In addition to the standard pin-end protective head, tips in other shapes can be provided on request.

### Industries

- ▶ Canning industry
- ▶ Food and beverage industries
- ▶ Pipe and tube industry
- ▶ Specialty applications

# Chains with special attachments

Roller chains with V-plate attachments convey cylindrical objects directly on the plate. Many assembled chains and components are stocked for quick delivery. Additional market standard and custom-made components can be supplied upon request. V-shaped plates can be spaced as desired upon request.

Available in nicked plate, delta tone, and stainless steel versions.

**SERVICES**

*Assembled chains available in stock*

*Specific product on request*

*V-plate attachments distanced as required*

*Chains of any length*

*Matched pairs on request*

*for chains working in parallel*

*Technical assistance*

## ISO SERIES

DIN/ISO No.	Material	Pitch	Roller diameter	Width between plates	Pin diameter	Pin length		Inner Plate depth	Plate thickness	Minimum Tensile strength	Weight per meter
		P mm	d1 max mm	b1 min mm	d2 max mm	L max mm	Lc max mm	h2 max mm	t/T max mm	Q min KN	q kg/m
08B-1	CS, NP, DT, SS	12,700	8,51	7,75	4,45	16,70	18,20	11,80	1,60	18,00	0,69
10B-1	CS, NP, DT, SS	15,875	10,16	9,65	5,08	19,50	20,90	14,70	1,70	22,40	0,93
12B-1	CS, NP, DT, SS	19,050	12,07	11,68	5,72	22,50	24,20	16,00	1,85	29,00	1,15
16B-1	CS, NP, DT, SS	25,400	15,88	17,02	8,28	36,10	37,40	21,00	4,15/3,1	60,00	2,71
20B-1	CS, NP, DT, SS	31,750	19,05	19,56	10,19	41,30	45,00	26,40	4,5/3,5	95,00	3,70

- CS CARBON STEEL
- DT DELTA-TONE
- SS STAINLESS STEEL

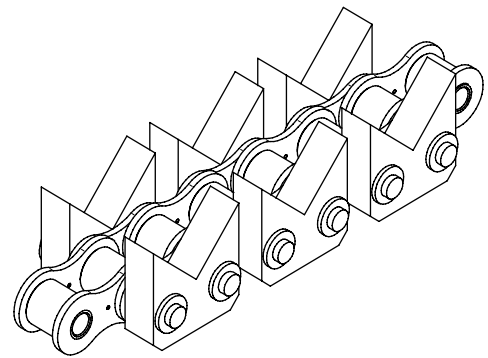
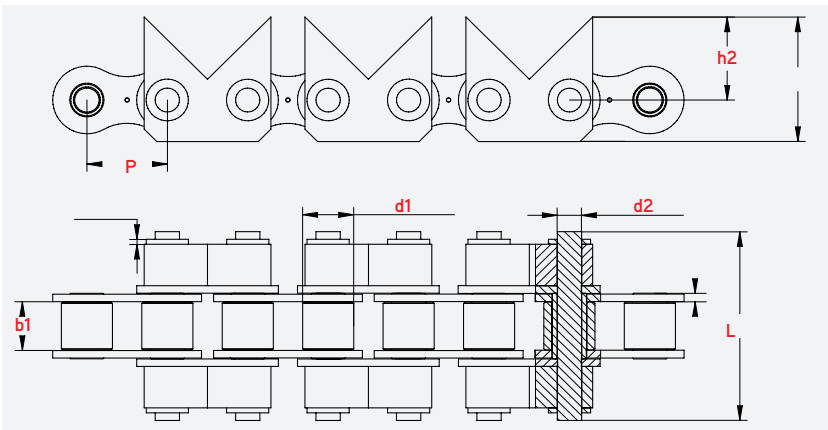

### Examples of chains with special attachments:

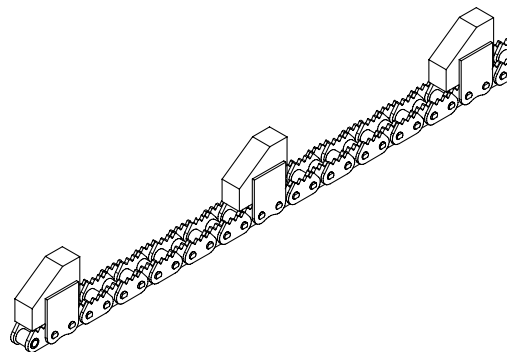
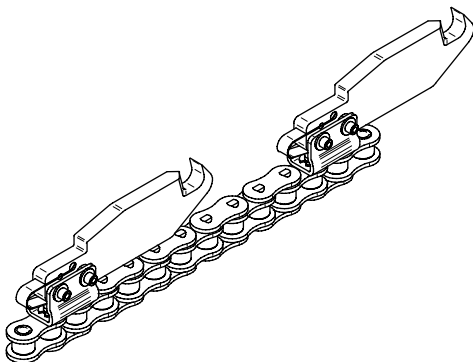

# Conveyor chains with straight fixed pushers

Roller chains with V-plate attachments convey cylindrical objects directly on the plate. Many assembled chains and components are stocked for quick delivery. Additional market standard and custom-made components can be supplied upon request. V-shaped plates can be spaced as desired upon request.

Available in nicked plate, delta tone, and stainless steel versions.

### SERVICES

Assembled chains **available in stock**

**Specific product on request**

**V-plate attachments distanced as required**

**Chains of any length**

**Matched pairs on request**

*for chains working in parallel*

**Technical assistance**

### ISO SERIES

ISO SERIES		Pitch	Roller diameter	Width between plates	Pin diameter	Pin length		Inner Plate depth	Plate thickness	Minimum Tensile strength	Weight per meter
DIN/ISO No.	Material	P mm	d1 max mm	b1 min mm	d2 max mm	L max mm	Lc max mm	h2 max mm	t/T max mm	Q min KN	q kg/m
08B-1	CS, NP, DT, SS	12,700	8,51	7,75	4,45	16,70	18,20	11,80	1,60	18,00	0,69
10B-1	CS, NP, DT, SS	15,875	10,16	9,65	5,08	19,50	20,90	14,70	1,70	22,40	0,93
12B-1	CS, NP, DT, SS	19,050	12,07	11,68	5,72	22,50	24,20	16,00	1,85	29,00	1,15
16B-1	CS, NP, DT, SS	25,400	15,88	17,02	8,28	36,10	37,40	21,00	4,15/3,1	60,00	2,71
20B-1	CS, NP, DT, SS	31,750	19,05	19,56	10,19	41,30	45,00	26,40	4,5/3,5	95,00	3,70

CS CARBON STEEL  
 DT DELTA-TONE  
 SS STAINLESS STEEL

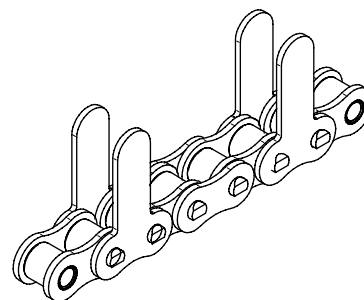
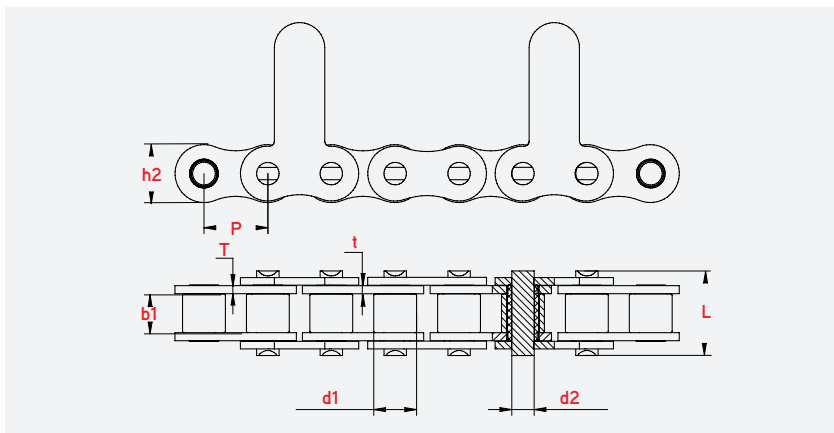

## Conveyor chains with straight fixed

### STRAIGHT PUSHER ATTACHMENT TYPES

STRAIGHT PUSHER

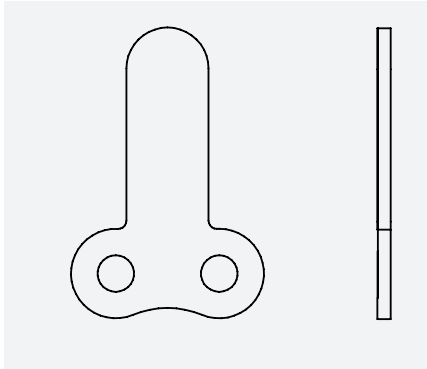

STRAIGHT PUSHER  
WITH TAIL

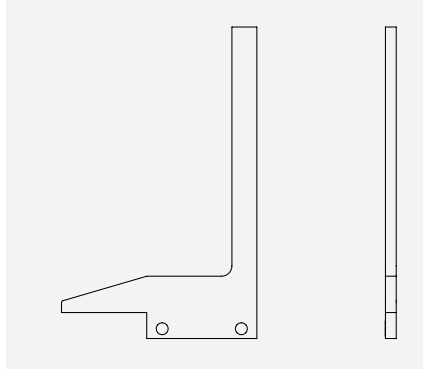

STRAIGHT PUSHER  
DOUBLE WIDTH

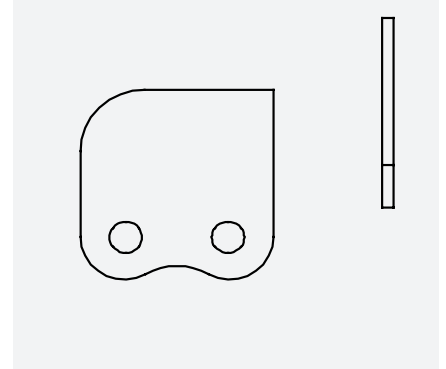

STRAIGHT PUSHER  
WITH FINGER

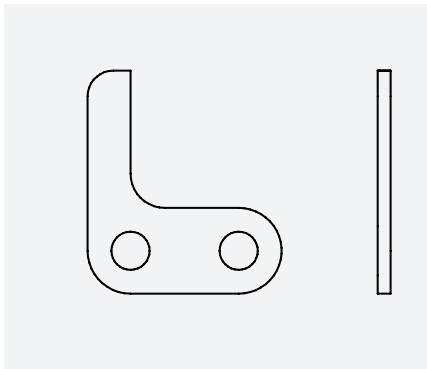

TRIANGULAR PUSHER

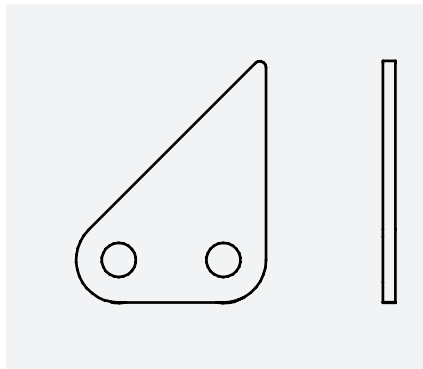

TRIANGULAR PUSHER  
WITH TAIL

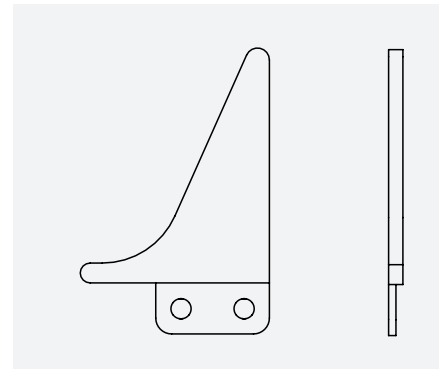

Fotos de cadenas  
empujadores fijos

# Chains with bent fixed pushers

Roller chains with V-plate attachments convey cylindrical objects directly on the plate. Many assembled chains and components are stocked for quick delivery. Additional market standard and custom-made components can be supplied upon request. V-shaped plates can be spaced as desired upon request.

Available in nickeled plate, delta tone, and stainless steel versions.

**SERVICES**

*Assembled chains **available in stock***

***Specific product on request***

***V-plate attachments distanced as required***

***Chains of any length***

***Matched pairs on request***

*for chains working in parallel*

***Technical assistance***

## ISO SERIES

ISO SERIES		Pitch	Roller diameter	Width between plates	Pin diameter	Pin length		Inner Plate depth	Plate thickness	Minimum Tensile strength	Weight per meter
DIN/ISO No.	Material	P mm	d1 max mm	b1 min mm	d2 max mm	L max mm	Lc max mm	h2 max mm	t/T max mm	Q min KN	q kg/m
08B-1	CS, NP, DT, SS	12,700	8,51	7,75	4,45	16,70	18,20	11,80	1,60	18,00	0,69
10B-1	CS, NP, DT, SS	15,875	10,16	9,65	5,08	19,50	20,90	14,70	1,70	22,40	0,93
12B-1	CS, NP, DT, SS	19,050	12,07	11,68	5,72	22,50	24,20	16,00	1,85	29,00	1,15
16B-1	CS, NP, DT, SS	25,400	15,88	17,02	8,28	36,10	37,40	21,00	4,15/3,1	60,00	2,71
20B-1	CS, NP, DT, SS	31,750	19,05	19,56	10,19	41,30	45,00	26,40	4,5/3,5	95,00	3,70

- CS** CARBON STEEL
- DT** DELTA-TONE
- SS** STAINLESS STEEL

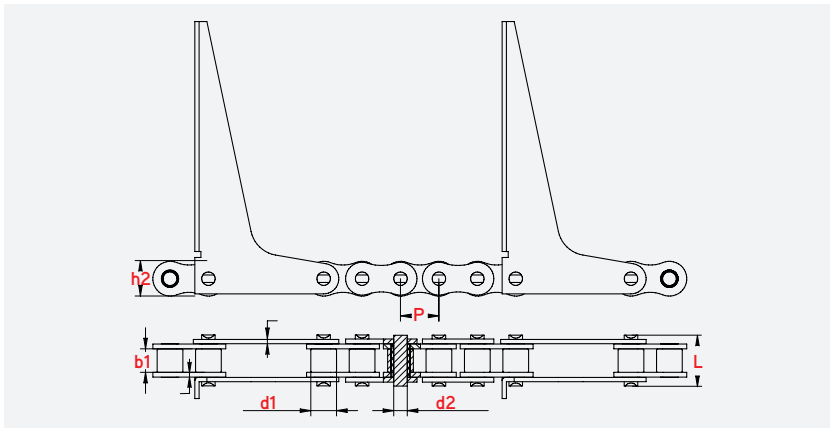

BENT PUSHER

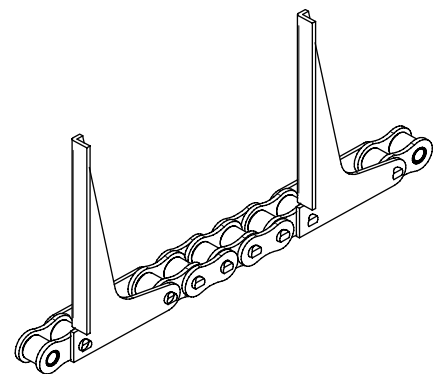
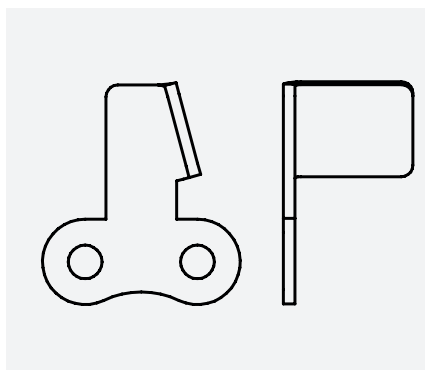

BENT PUSHER WITH TAIL

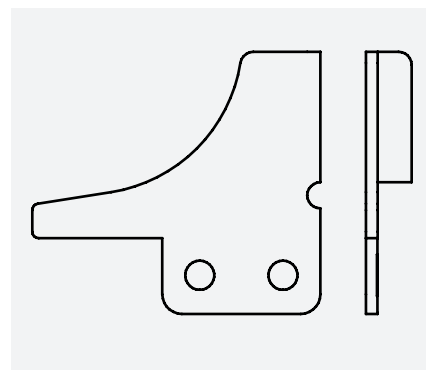

## Chains with pusher dogs

Roller chains with V-plate attachments convey cylindrical objects directly on the plate. Many assembled chains and components are stocked for quick delivery. Additional market standard and custom-made components can be supplied upon request. V-shaped plates can be spaced as desired upon request.

Available in nicked plate, delta tone, and stainless steel versions.

### SERVICES

*Assembled chains available in stock*

*Specific product on request*

*V-plate attachments distanced as required*

*Chains of any length*

*Matched pairs on request*

*for chains working in parallel*

*Technical assistance*

### ISO SERIES

DIN/ISO No.	Material	Pitch	Roller diameter	width between plates	Pin diameter	Pin length		Inner Plate depth	Chain to top height	Chain to top height	Plate thickness	Minimum Tensile strength	Weight per meter
		P mm	d1 max mm	b1 max mm	d2 max mm	L max mm	Lc max mm	H mm	h mm	h2 mm	t/T max mm	Q min KN	q kg/m
32B-1	CS, DT, SS	50,800	29,21	31,00	17,81	66,00	71,00	72,00	27	42,2	7,00/6,00	277,5	10,25

## Chains with side return pushers

Roller chains with V-plate attachments convey cylindrical objects directly on the plate. Many assembled chains and components are stocked for quick delivery. Additional market standard and custom-made components can be supplied upon request. V-shaped plates can be spaced as desired upon request.

Available in nickeled plate, delta tone, and stainless steel versions.

### SERVICES

*Assembled chains available in stock*

*Specific product on request*

*V-plate attachments distanced as required*

*Chains of any length*

*Matched pairs on request*

*for chains working in parallel*

*Technical assistance*

### ISO SERIES

DIN/ISO No.	Material	Pitch	Roller diameter	width between plates	Pin diameter	Pin length		Inner Plate depth	Chain to top height	Chain to top height	Plate thickness	Minimum Tensile strength	Weight per meter
		P mm	d1 max mm	b1 max mm	d2 max mm	L max mm	Lc max mm	H mm	h mm	h2 mm	t/T max mm	Q min KN	q kg/m
32B-1	CS, DT, SS	50,800	29,21	31,00	17,81	66,00	71,00	72,00	27	42,2	7,00/6,00	277,5	10,25