

**iRIS**  
chains

[www.iris-chains.com](http://www.iris-chains.com)

SINCE  
**1935**

## Roller chains with tip shaped plates

IRIS sticker chains serve the purpose of conveying plastic film in thermoforming applications, with absolute precision

## Roller chains with tip shaped plates

Our sticker chains serve the purpose of conveying plastic film in thermoforming applications, with absolute precision.

IRIS develops sticker chains that adapt to specific client requirements and applications, either by combining the guide roller chain and attachment plate designs that we introduce, or by developing tailor-made designs and customizations for specified client requests.

### SERVICES

*Many references **available in stock.***

**Corrosion-resistant versions available**  
*(delta tone, stainless steel).*

**Specific designs on request**

**Matched pairs on request for**  
*chains working in parallel.*

**Chains of any length.**

**Technical assistance.**

**Special lube at request for extreme temperatures**

### Highlights

- ▶ Dimensions according to ISO 606.
- ▶ Exact length tolerance for precise film alignment.
- ▶ Higher fatigue strength due to optimized press fit of pin and outer plate.
- ▶ Higher wear resistance thanks to optimize plate hardness
- ▶ Minimum elongation and a long service life
- ▶ Hardened sticker profiles for precise handling of material handling

### Base options

Our base options are styled after the machine design of well-know operators in the industry:

Name	Trade name registered by
Bellaplast®	SwissPrimePack AG
Dinieper®	Dinieper Ind. Metalurgica
Gabler®	Gabler Thermoform GmbH
ILLIG®	ILLIG Maschinenbaum GmbH
Irwin®	Irwin Research and Development Inc.
Kiefel®	Kiefel GmbH
OMW®	OMW Machinery Srl
TFT®	WM Wrapping Machinery SA



# Roller chains with tip shaped plates

## Customization options

Clients can design the conveyor chain they need for their specific application by combining the base option guide rollers with the attachment plate options shown below.

IRIS has additional attachment plate design available and can develop tailor-made designs and customizations to meet the client requests.

GUIDE ROLLER OPTIONS		ATTACHMENT PLATE OPTIONS	
		<b>Guided on Chain rollers</b>	 <b>Standard</b>
		<b>Guided on Saddle</b>	 <b>Coined</b>
		<b>Guided on Extended pin</b>	 <b>Deep Link</b>
		<b>Guided on Single Outboard roller</b>	 <b>Asymmetric</b>
		<b>Guided on Double Outboard roller</b>	 <b>Chisel</b>

Additional attachment designs at request

# Roller chains with tip shaped plates 1/2"

GUIDED ON CHAIN ROLLER - COINED - ILLIG, TFT, WM type

DIN/ISO No.	Material	Pitch	Roller diameter	width between plates	Pin diameter	Pin length		Inner Plate height	Attachment dimensions			Traverse pitch	Plate thickness	Minimum Tensile strength	Weight per meter
		P mm	d1 max mm	b1 min mm	d2 max mm	L max mm	Lc max mm	L2 mm	H mm	A °	B °	TP mm	t/T max mm	Q min KN	q kg/m
08B-2	CS, DT, SS	12,700	8,51	7,75	4,45	16,70	18,20	11,80	14,60	30,00	15,00	13,92	1,60	38,70	1,31

CS CARBON STEEL  
DT DELTA-TONE  
SS STAINLESS STEEL

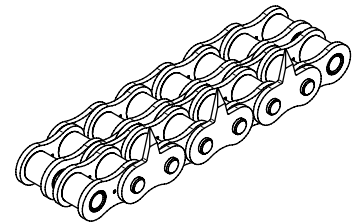
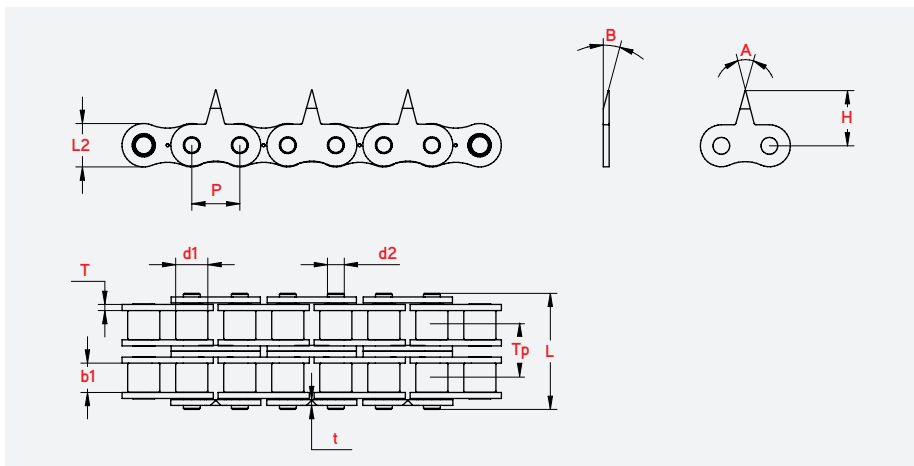

GUIDED ON SINGLE OUTBOARD ROLLER - COINED - GABLER, KIEFER type

DIN/ISO No.	Material	Pitch	Roller diameter	width between plates	Pin diameter	Pin length		Inner Plate height	Attachment dimensions					Traverse pitch	Plate thickness	Minimum Tensile strength	Weight per meter
		P mm	d1 max mm	b1 min mm	d2 max mm	L max mm	Lc max mm	L2 mm	H mm	A °	B °	h mm	d3 mm	TP mm	t/T max mm	Q min KN	q kg/m
08B-2	CS, DT, SS	12,700	8,51	7,75	4,45	16,70	18,20	8,51	14,50	30,00	10,00	7,50	8,51	13,92	1,60	38,70	1,56

CS CARBON STEEL  
DT DELTA-TONE  
SS STAINLESS STEEL

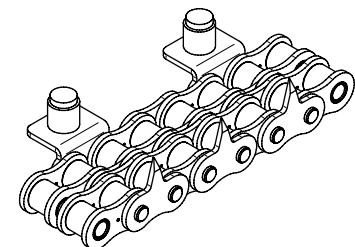
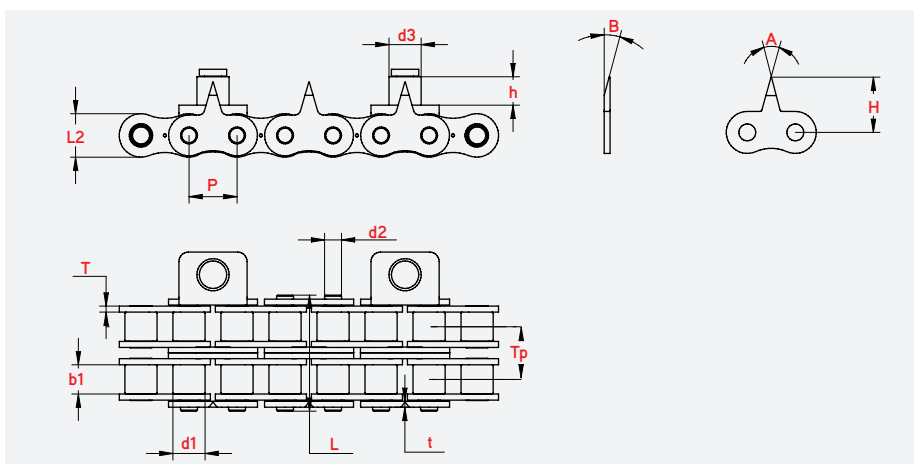

# Roller chains with tip shaped plates 1/2"

GUIDED ON DOUBLE OUTBOARD ROLLER - COINED

DIN/ISO No.	Material	Pitch	Roller diameter	width between plates	Pin diameter	Pin length		Inner Plate height	Attachment dimensions			Traverse pitch	Plate thickness	Minimum Tensile strength	Weight per meter
		P mm	d1 max mm	b1 min mm	d2 max mm	L max mm	Lc max mm	L2 mm	H mm	A °	B °	TP mm	t/T max mm	Q min KN	q kg/m
08B-2	CS, DT, SS	12,700	8,51	7,75	4,45	16,70	17,70	8,51	14,50	30,00	10,00	13,92	1,60	38,70	1,73

CS CARBON STEEL  
DT DELTA-TONE  
SS STAINLESS STEEL

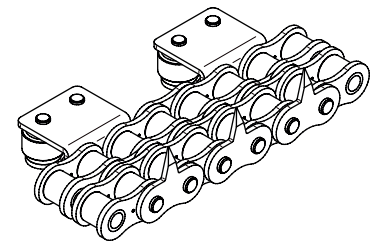
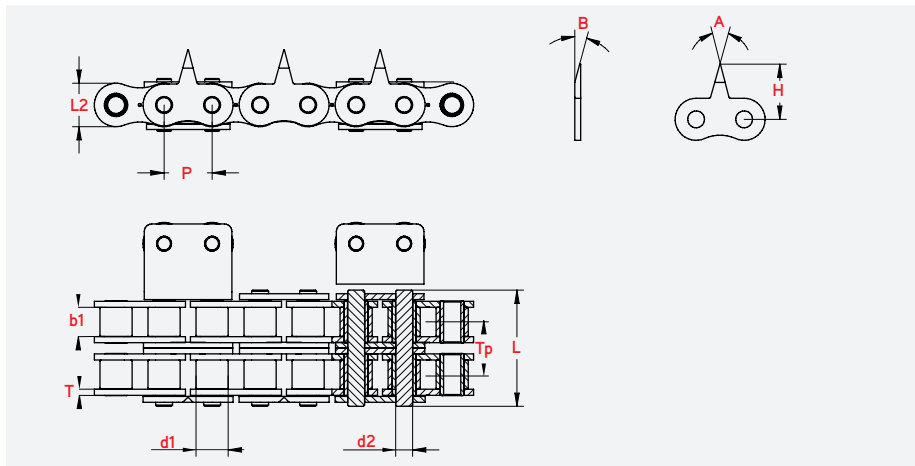

GUIDED ON CHAIN ROLLER - DEEP LINK - ILLIG, TFT, WM type

DIN/ISO No.	Material	Pitch	Roller diameter	width between plates	Pin diameter	Pin length		Inner Plate height	Attachment dimensions			Traverse pitch	Plate thickness	Minimum Tensile strength	Weight per meter
		P mm	d1 max mm	b1 min mm	d2 max mm	L max mm	Lc max mm	L2 mm	H mm	A °	B °	TP mm	t/T max mm	Q min KN	q kg/m
08B-2	CS, DT, SS	12,700	8,51	7,75	4,45	16,70	18,20	11,80	14,85	34,00	15,00	13,92	1,60	38,70	1,42

CS CARBON STEEL  
DT DELTA-TONE  
SS STAINLESS STEEL

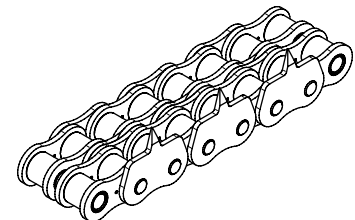
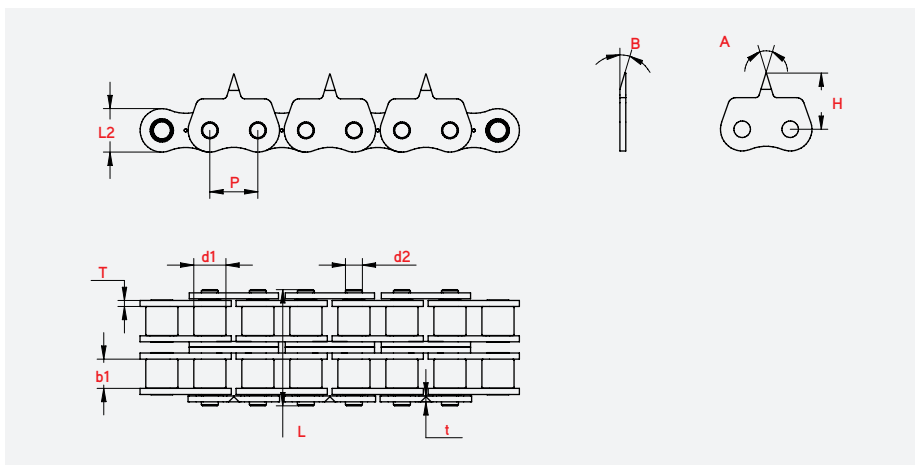

# Roller chains with tip shaped plates 1/2"

GUIDED ON EXTENDED PIN - ASYMMETRIC - IRWIN type

DIN/ISO No.	Material	Pitch	Roller diameter	width between plates	Pin diameter	Pin length		Inner Plate height	Attachment dimensions		Plate thickness	Minimum Tensile strength	Weight per meter
		P mm	d1 max mm	b1 min mm	d2 max mm	L max mm	Lc max mm	L2 mm	H mm	A °	t/T max mm	Q min KN	q kg/m
08A-1	CS, DT, SS	12,700	7,95	7,85	3,96	24,80	26,30	12,00	12,30	23,00	1,50	17,50	0,73

CS CARBON STEEL  
DT DELTA-TONE  
SS STAINLESS STEEL

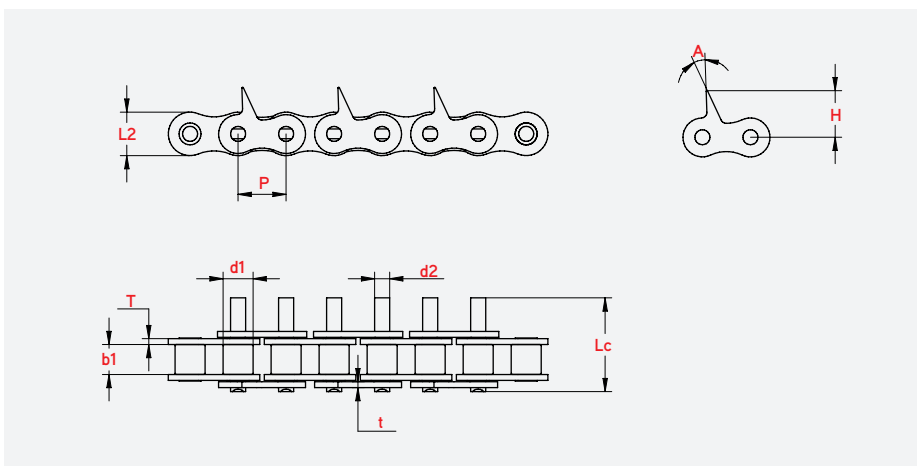

GUIDED ON EXTENDED PIN - CHISEL - IRWIN type

DIN/ISO No.	Material	Pitch	Roller diameter	width between plates	Pin diameter	Pin length		Inner Plate height	Attachment dimensions		Plate thickness	Minimum Tensile strength	Weight per meter
		P mm	d1 max mm	b1 min mm	d2 max mm	L max mm	Lc max mm	L2 mm	H mm	A °	t/T max mm	Q min KN	q kg/m
08A-1	CS, DT, SS	12,700	7,95	7,85	3,96	24,80	26,30	12,00	12,30	23,00	1,50	17,50	0,73

CS CARBON STEEL  
DT DELTA-TONE  
SS STAINLESS STEEL

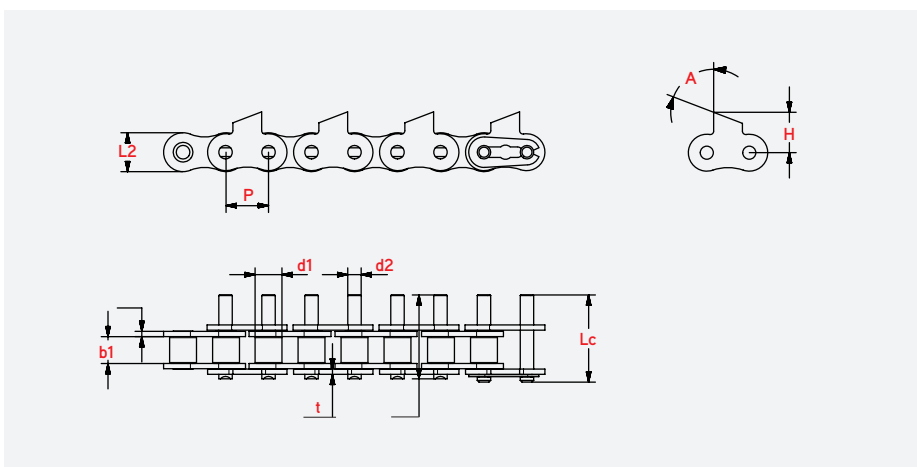

# Roller chains with tip shaped plates 1/2"

GUIDED ON CHAIN ROLLER - COINED - DINIEPER type

DIN/ISO No.	Material	Pitch	Roller diameter	width between plates	Pin diameter	Pin length		Inner Plate height	Attachment dimensions			Plate thickness	Minimum Tensile strength	Weight per meter
		P mm	d1 max mm	b1 min mm	d2 max mm	L max mm	Lc max mm	L2 mm	H mm	A ϕ	B ϕ	t/T max mm	Q min KN	q kg/m
08A-1	CS, DT, SS	12,700	7,95	7,85	3,96	24,80	26,30	12,00	12,30	23,00	10,00	1,50	17,50	0,73

CS CARBON STEEL  
DT DELTA-TONE  
SS STAINLESS STEEL

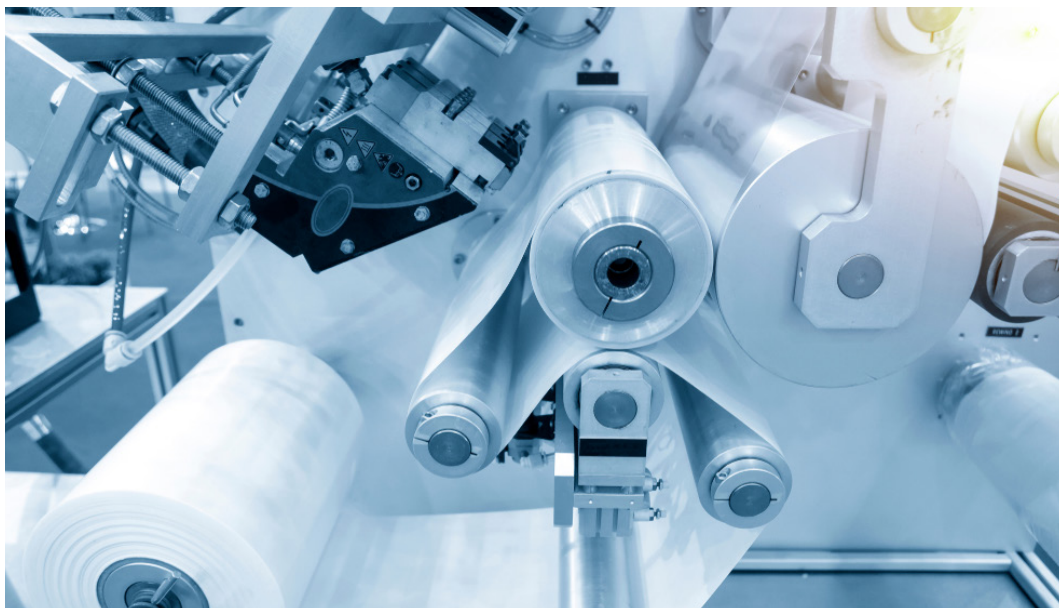
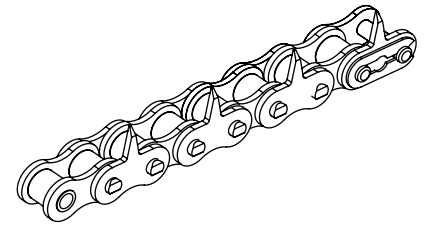
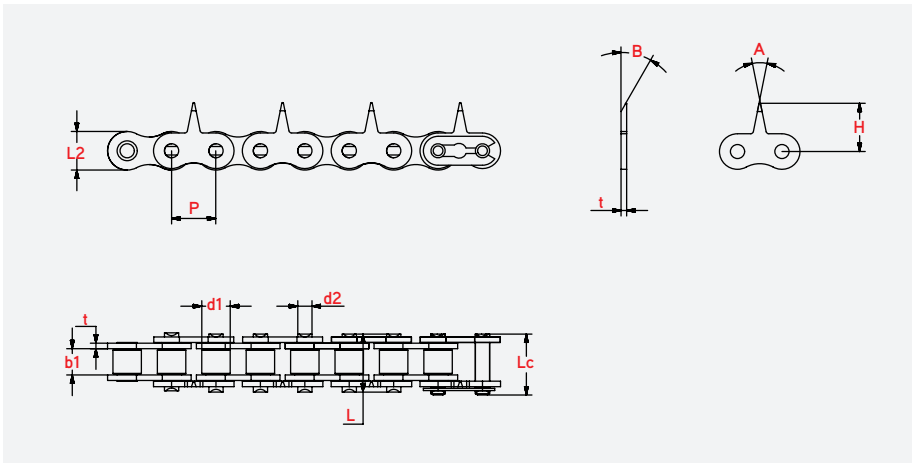

# Roller chains with tip shaped plates 5/8"

GUIDED ON EXTENDED PIN - COINED

DIN/ISO No.	Material	Pitch	Roller diameter		Pin diameter		Pin length		Inner Plate height	Attachment dimensions			Plate thickness	Minimum Tensile strength	Weight per meter
		P mm	d1 max mm	b1 min mm	d2 max mm	L max mm	Lc max mm	L2 mm	H mm	A °	B °	t/T max mm	Q min KN	q kg/m	
10A-1	CS, DT, SS	15,875	7,95	7,85	3,96	24,80	26,30	12,00	12,30	23,00	11,00	1,50	17,50	0,73	

CS CARBON STEEL  
DT DELTA-TONE  
SS STAINLESS STEEL

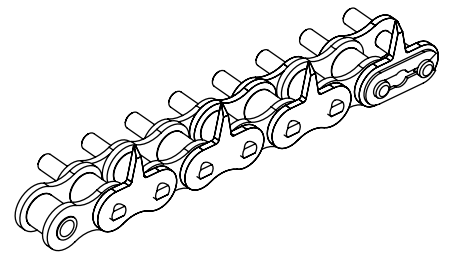
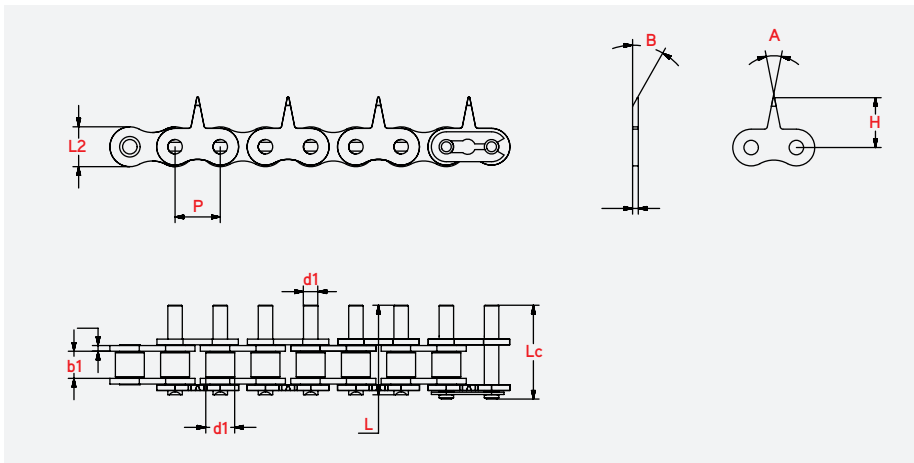

GUIDED ON SADDLE - COINED

DIN/ISO No.	Material	Pitch	Roller diameter		Pin diameter		Pin length		Inner Plate height	Attachment dimensions						Plate thickness	Minimum Tensile strength	Weight per meter
		P mm	d1 max mm	b1 min mm	d2 max mm	L max mm	Lc max mm	L2 mm	H mm	A °	B °	F mm	C mm	G mm	d3 mm	t/T max mm	Q min KN	q kg/m
10A-1	CS, DT, SS	15,875	10,16	9,40	5,08	20,70	22,20	15,09	17,50	22,34	30,00	23,20	16,00	12,80	5,30	2,00	29,40	1,02

CS CARBON STEEL  
DT DELTA-TONE  
SS STAINLESS STEEL

